

Klick-System



- EXTRA
- Cardholder
- Klick shelf barker
- Price cassettes
- Accessories Klick
- Shopper stopper



NEW!

For your EXTRA of information!

The holder is especially suitable for fashion and technical articles if you want to place more information than simply the price. In combination with the proven Klick accessories it can be used as support and stand in different heights in shop windows, shelves and on slatwalls. Be inspired by the variety of combinations this elegant assistant is offering!

Klick label holder EXTRA

To insert 6 labels, size 110x25 mm, max. thickness 0,9 mm, with Klick adaptor on the rear. External size: 110x175 mm. Colours: white, grey, anthracite.

13300-xx.....SU 10

EXTRA 301

EXTRA with support (301), grey.
36500-03.....SU 10

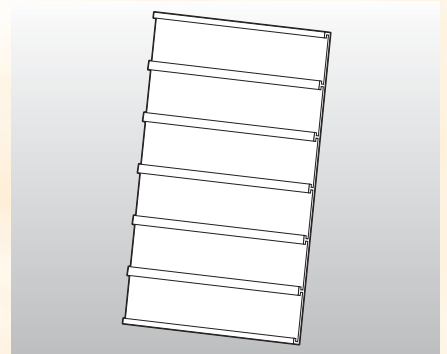

EXTRA PVC cover (set)

To cover labels, PVC anti reflective, size: 110x26x0,4 mm, clear. Packing unit: 60 pcs per set.

24142-00.....SU 1



EXTRA with KL base

KL base, grey with aluminium tube, Ø 6 mm, lengths 200 and 400 mm, with label holder EXTRA, grey.

EXTRA 200 with KL base

36600-03/200.....SU 10

EXTRA 400 with KL base

36600-03/400.....SU 10



CARDHOLDER

...and here you are with all trumps on one hand! The solution to effectively present also small labels and cards: easy to insert, quick to change and with an effective appearance. For suitable chalk boards please see chapter "Klick-accessories".

NEW!



Mini-Cardholder

For signs made of paper, carton etc. with a thickness of 0,3 - 1,3 mm and a max. size of 100 x 80 mm, width 25 mm, white. To be used with *Klick-accessories* or to be used alone in standing position.

17010-01SU 10

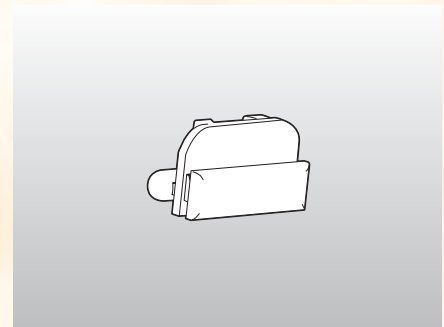

Mini-Cardholder with universal clip

Delicatessen clip for universal use, consisting of Mini-cardholder and universal clip (356). Colour: white. Not assembled.

36010-01SU 10

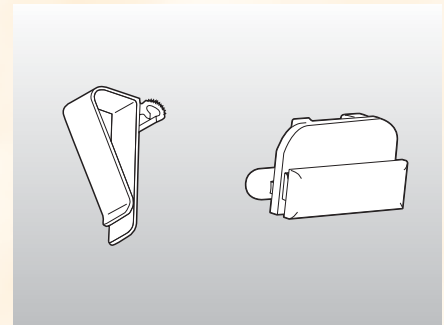

Cardholder

For signs made of paper, carton etc. with a thickness of 0,3 to 1,0 mm, width 60 mm. Colours: clear, white or grey. To be used with *Klick accessories*.

17000-xxSU 10

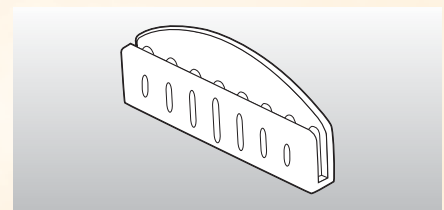

Cardholder with tray clip

Tray clip to fit delicatessen trays, consisting of Cardholder, rod (354) and tray clip (355). Colours: clear, white. Not assembled.

36000-xxSU 10

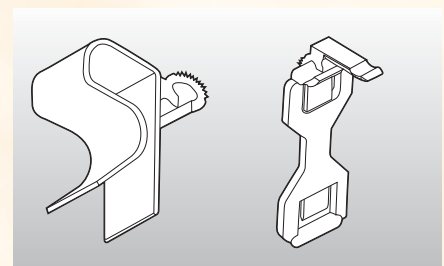



Cardholder with FK stand

Cardholder with rod in 50, 100 and 200 mm lengths with FK base. Colours: clear, white

Cardholder with FK stand 50

36030-xx.....SU 10

Cardholder with FK stand 100

36031-xx.....SU 10

Cardholder with FK-stand 200

36032-xx.....SU 10

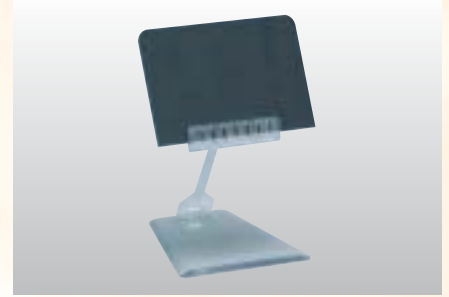

Cardholder with KL base

KL base grey with aluminium tube, Ø 6 mm in 200 and 400 mm lengths and Cardholder grey.

Cardholder 200 with KL base

36100-03/200.....SU 10

Cardholder 400 with KL base

36100-03/400.....SU 10



Stake with Cardholder

Aluminium tube, Ø 6 mm in 200, 400, 600 and 800 mm lengths with plastic stake and Cardholder grey.

Stake 200 with Cardholder

36101-03/200.....SU 10

Stake 400 with Cardholder

36101-03/400.....SU 10

Stake 600 with Cardholder

36101-03/600.....SU 10

Stake 800 with Cardholder

36101-03/800.....SU 10



Clampholder

Clampholder with Klick adaptor and 100 mm wide clamp to take signs up to 5 mm thickness, clear. Can be used with *Klick accessories*.

17060-00.....SU 10

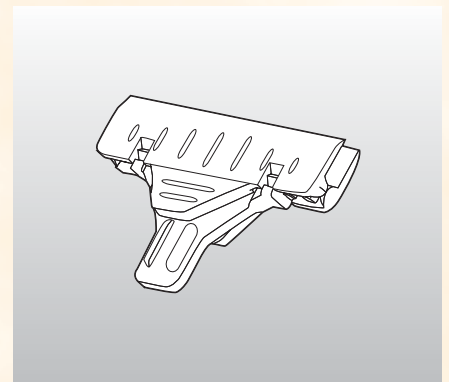



Clamholder with Cardboard clamp 20 -Klick-

For signage at containers, trays and baskets up to a wall thickness of 20 mm, clear.

36050-00SU 10

Clamholder with FK stand

Clamholder with Klick adaptor and 100 mm wide clamp to take signs up to 5 mm thickness, with rod in 50, 100 and 200 mm lengths and FK base, clear.

Clamholder with FK stand 50

36035-00SU 10

Clamholder with FK stand 100

36036-00SU 10

Clamholder with FK stand 200

36037-00SU 10

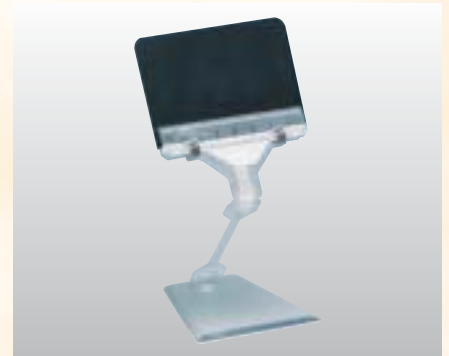

Clamholder for tubes

Clamholder with tube adaptor Ø 10 mm, 100 mm wide clamp to take signs up to 5 mm thickness, clear

17050-00SU 10

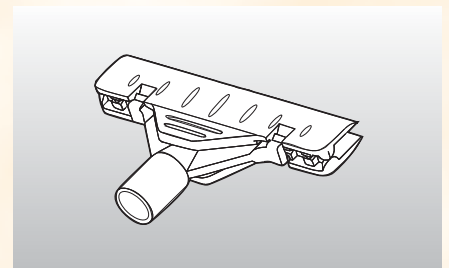

Showcard stand CH

Clamholder with tube adaptor, 100 mm wide clamp, clear with fixed chromium tube 310 mm or adjustable tube 320-620 mm with lever clamp and round plastic base, Ø 160 mm, grey.

Fixed showcard stand CH

33419-35/310SU 5

Adjustable showcard stand CH

33429-35/310-620SU 5

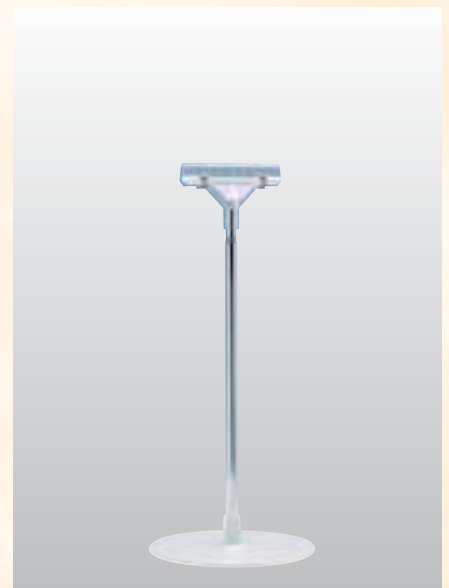



Klick shelf barker

Made of high-grade unbreakable plastics with rear Klick adaptor. Fasteners are inserted between the dovetail guides on the rear of the barker and locked securely into place with an audible "Klick". You will find suitable accessories under chapter "Accessories Klick". Barkers available in OEK standard colours, silver and chromium plated. All DIN sizes also available in gold.

- A9**
13090-xx.....SU 10

- A8**
13080-xx.....SU 10

- A7**
13070-xx.....SU 10

- A6**
13060-xx.....SU 10

- 148x70 mm**
13004-xx.....SU 10

- 210x59 mm**
13003-xx.....SU 10

- 210x74 mm**
13002-xx.....SU 10

- 210x99 mm**
13001-xx.....SU 10

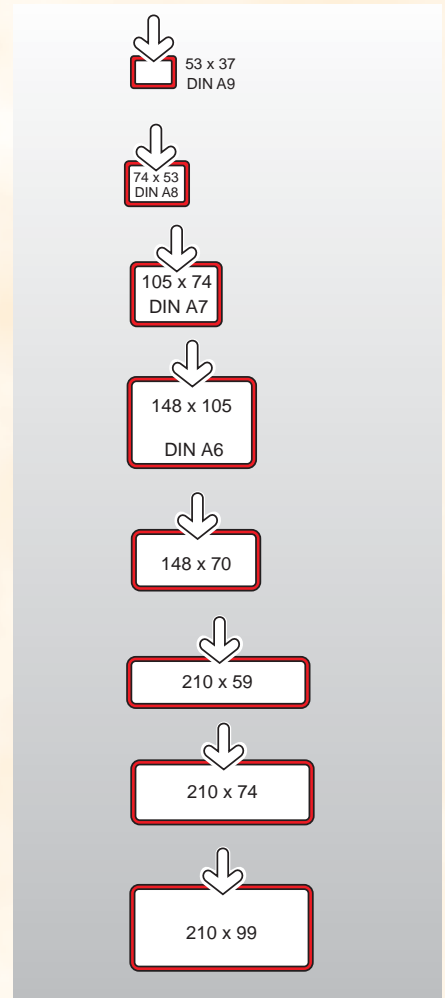

Klick acrylic barker



The alternative to present your message to the customer in a glass-clear way. The print is completely covered and protected - without distracting border or colour, clear.

A8
13580-25SU 10

A7
13570-25SU 10

A6 portrait
13561-25SU 10

A6 landscape
13560-25SU 10

148x70 mm
13504-25SU 10

210x74 mm
13502-25SU 10

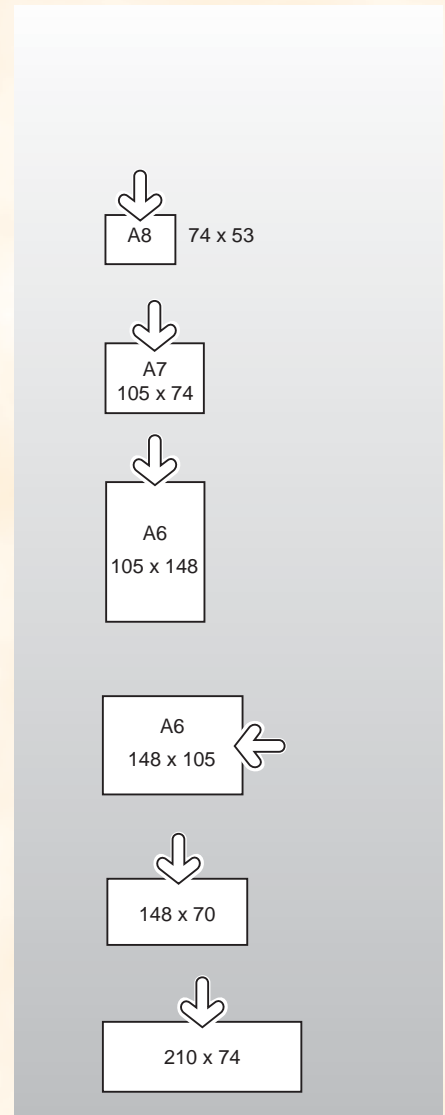

Price cassettes

In combination with printed number strips price barkers and cassettes offer a quick and neat price marking. The system is professionally completed by a big choice of suitable fasteners of the Klick accessories range.

Price barkers TPS 110x85

Made of high-grade unbreakable plastic, for 6-digit number strips, with rear Klick adaptor. OEK standard colours. Overall size 110 x 85 mm, size for wording 104 x 40 mm, without number strips, wording and clear PVC protective cover

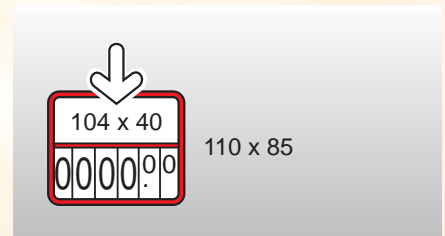

13191-xx.....SU 10

PVC protective cover for TPS 110x85

PVC cover 104 x 40 mm, clear
24145-00.....SU 10

Plain cutting for wording for TPS 110x85

PVC cutting 104 x 40 mm, white
24145-01.....SU 10

Lettering upon request



Price barkers TPS 215x85

Made of high-grade unbreakable plastic, for 5-digit number strips, with rear Klick adaptor. OEK standard colours. Overall size 215 x 85 mm, size for wording 90 x 35 and 120 x 70 mm, without number strips, wording and clear PVC protective cover

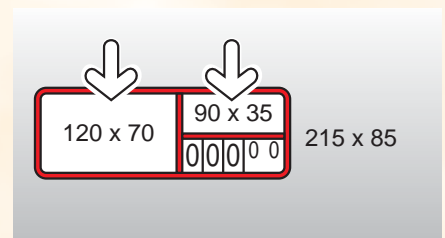

13193-xx.....SU 10

PVC protective cover for TPS 215x85

PVC cover 90 x 40 mm, clear
24130-00.....SU 10

Plain cutting for wording for TPS 215x85

PVC cutting 90 x 35 mm, white
24130-01.....SU 10

Lettering upon request

Folded number strips for TPS 110x85 & TPS 215x85

Made of white PVC printed black with big and small digits or big digits only, sheet 214 x 87 mm with 6 number strips, 214 x 15 mm each.

Big and small digits

24105-00.....SU 10

Big digits only

24105-01.....SU 10

Price barkers TPS 155x110

Made of high-grade unbreakable plastic, for 6-digit number strips, with rear Klick adaptor. OEK standard colours. Overall size 155 x 110 mm, size for wording 148 x 57 mm, without number strips and wording.

13192-xx.....SU 10

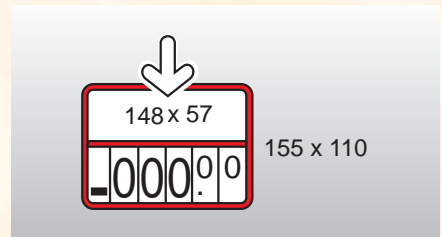

Lettering upon request

Plain cutting for wording for TPS 155x110

PVC cutting 148 x 57 mm, white
24126-02.....SU 10

Folded number strips for TPS 155x110

Made of white PVC printed black with big and small digits or big digits only and additional information such as weight, piece etc., sheet 269 x 129 mm with 6 number strips, 269 x 21,5 mm each.

Big and small digits

24126-00.....SU 10

Big digits only

24126-01.....SU 10

Price cassette PK 60x90

Price cassette made of high-grade unbreakable plastic, nearly closed, for 6-digit number strips, with rear Klick adaptor. OEK colours: white, grey, yellow, red, blue, green and brown. Overall size 60 x 94 mm, size for wording 83 x 21 mm, without number strips and wording.

13209-xx.....SU 10

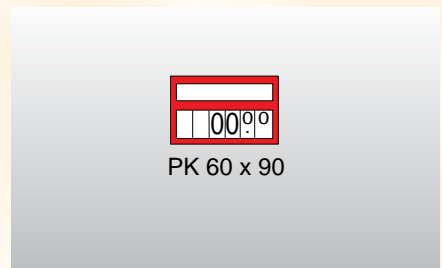

Lettering upon request

Folded number strips for PK 60x90

Made of white PVC printed black with big and small digits, additives, country of origin and information such as weight, piece etc. Sheet 108 x 155 mm with 9 strips 155 x 12 mm each.

24200-00.....SU 10

Plain cutting for wording for PK 60x90

PVC cutting 83 x 21 mm, white
24128-01.....SU 10





Price cassette OG 70x140

Price cassette especially for fruit and vegetables, made of high-grade unbreakable plastic, nearly closed, for 9-digit number strips, with rear Klick adaptor. OEK colour: green. Overall size 70 x 142 mm, size for wording 83 x 21 mm, without number strips and wording.

13219-07SU 10

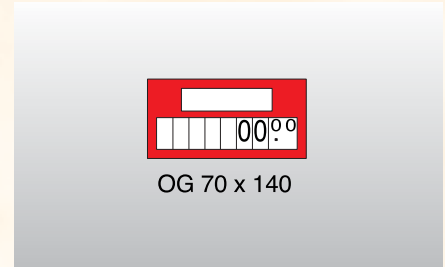

Folded number strips for OG 70x140

Made of white PVC printed black with big and small digits, country of origin, trade class, scale numbers and information such as weight, piece etc., sheet 192 x 132 mm with 11 strips 192 x 12 mm each.

24210-00SU 10

Plain cutting for wording for OG 70x140

PVC cutting 83 x 21 mm, white

24128-01SU 10

Lettering upon request



Price cassette 60x75

Price cassette with rear Klick adaptor, complete with 6 digit number strips for bread and bakery made of white PVC printed black (no wording). Colours: white, black. Overall size 72 x 60 mm, packing unit: 25 pieces.

13241-xxSU 25

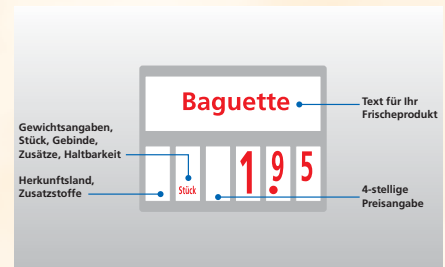

Price cassette 160x90

Price cassette especially for fruit and vegetables, with rear Klick adaptor, complete with 7 digit number strips made of white PVC printed green (no wording). Colours: white, green, black. Overall size 162 x 88 mm, packing unit: 25 pieces.

13230-xxSU 25

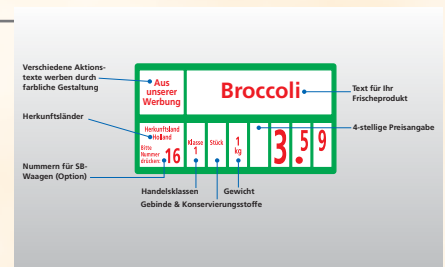

Accessories Klick (series 300)



All fasteners are designed to fit the dovetail guides on the rear of the frames, where they are locked in securely with an audible "klick". The listed accessories are suitable for Klick barker, acrylic barker, Klick label holder EXTRA, cardholder, clampholder as well as for price barker and cassette, thus offering countless possibilities of combinations and use.

Support (301)

Support and spacer, colours: clear, white and grey

23750-xx.....SU 10

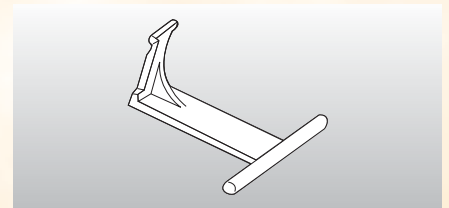

Hook clip (302)

For wire baskets, containers etc., fits wires up to Ø 10 mm. For sloping-fronted wire baskets, we recommend combination with support and spacer (301), white.

23300-26.....SU 10



Fastener for vertical glass panels (309)

Fits panels up to 8 mm thickness, white

23320-26.....SU 10

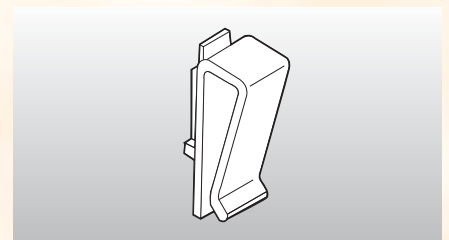

Fastener for vertical fine-gauge mounting strips (312)

Fits thin metal shelving with folded front or similar, white

23330-26.....SU 10

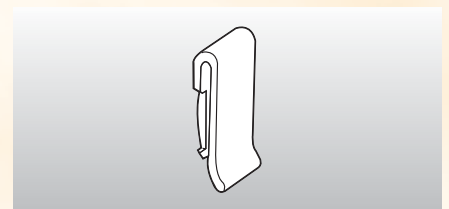

Hook clip (307)

For wire baskets, fine tubes etc. Fits wires/tubes up to Ø 20 mm, white

23310-26.....SU 10

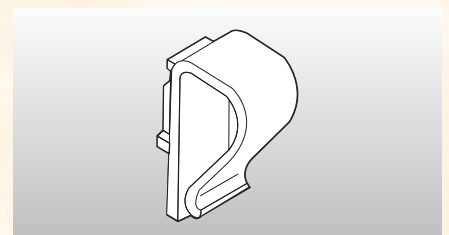



Cardboard clamp 10

To attach Klick barkers to cartons or cardboard boxes up to 10 mm wall thickness, clear

23710-00.....SU 10

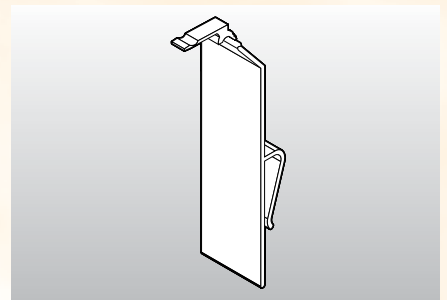

Cardboard clamp 20 -Klick-

To attach Klick barkers to containers, trays and baskets up to 20 mm wall thickness, clear

23715-00.....SU 10



Fastener for ledges (316)

For ledges up to 10 mm thickness, white

23160-26.....SU 10

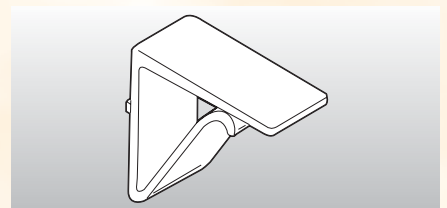

Coil-spring fastener (319)

For tables, shelves etc., up to a thickness of 60 mm, 1-part, white.

23100-26.....SU 10

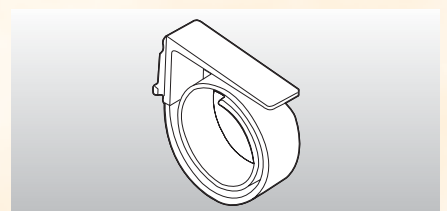

Fastener with coil-spring (320)

For thick tables, shelves etc., up to a thickness of 60 mm, 2-part, roll white, upper part clear.

23110-26.....SU 10

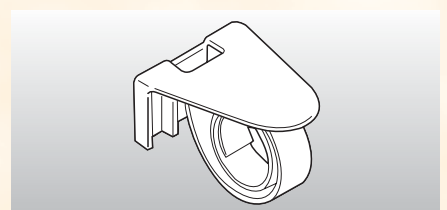



Clip fastener for Tegometall shelves (305)

Price ticket in an angled position, white.

23610-26SU 10

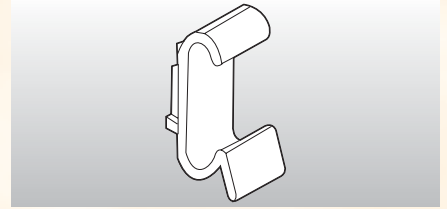

Clip fastener for Linde shelves (306)

Price ticket in a 90° position, white.

23620-26SU 10

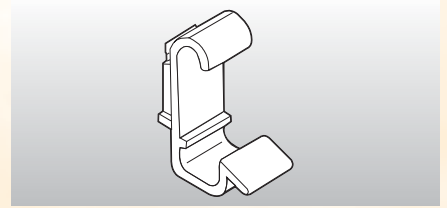

Clip fastener for ticket rail (304)

Clip for 40 mm wide ticket rail, clips outside, white.

23640-26SU 10

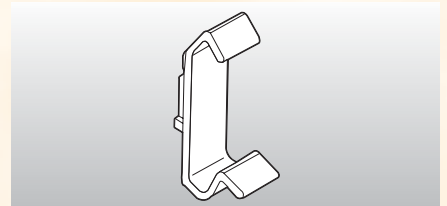

Clip fastener for ticket rail 15° (304a)

Clip for 40 mm wide ticket rail, clips outside with a 15° angle, white.

23650-26SU 10

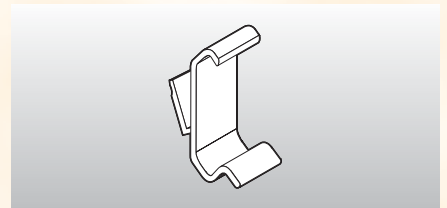

Clip fastener for ticket rail (322)

Clip for 26 mm wide ticket rail, clips outside, white.

23630-26SU 10

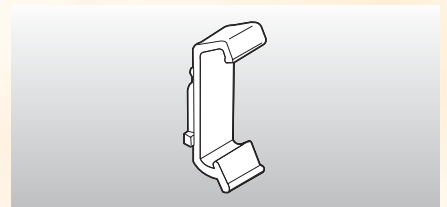

Pendulum clip fastener for Tegometall shelves (323)

Clip with longer arm, made of flexible plastics, white.

23600-26SU 10

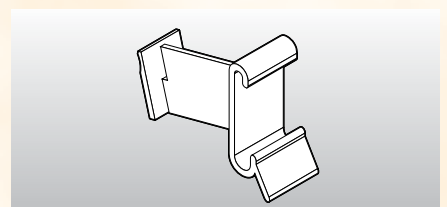



Clip fastener for ticket rail (303)

Clip for 40 mm wide ticket rail, clips inside, white.

23560-26SU 10

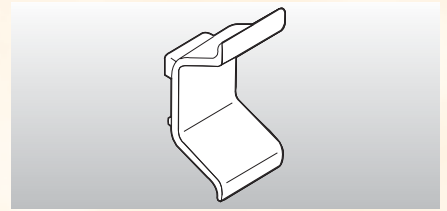

Clip fastener for ticket rail (324)

Clip for 30 mm wide ticket rail, clips inside, white.

23540-26SU 10

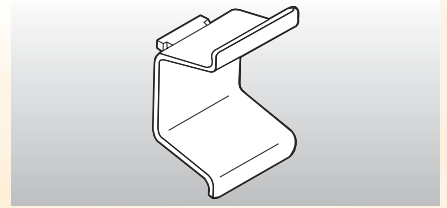

Clip fastener for ticket rail (330)

Clip for 50 mm wide ticket rail, clips inside, white.

23570-26SU 10

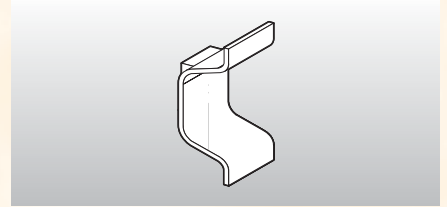

Magnetic fastener vertical (313)

For a quick attachment of Klick barkers to shelves and rear panels without causing damage. Colours: clear, white and grey.

23220-xxSU 10

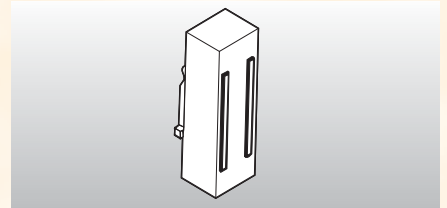

Magnetic fastener horizontal (329)

Same as magnetic fastener (313) but for horizontal attachment, clear.

23225-00SU 10

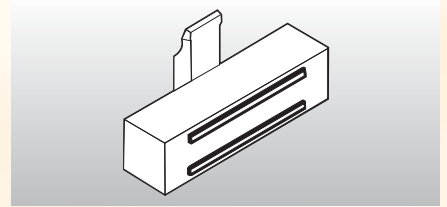

Magnetic swing fastener (311)

The Klick barker is attached to the shelf etc. from below. It can be pressed downwards to make the EAN label readable. We recommend to use two fasteners, white.

23125-26SU 10

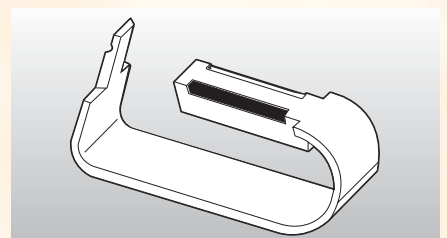



Claw fastener (314)

For wire baskets, wire-lattice etc., fits wires up to Ø 5 mm, white.

23410-26SU 10

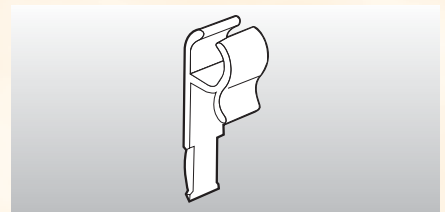

Clip for wire baskets (604)

Suitable for wire distances up to 40 mm with a wire Ø of 2 - 5 mm, white.

26040-26SU 10

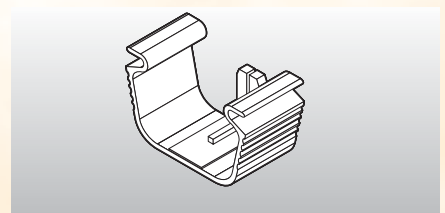

Sloping fastener (317)

For horizontal wire shelvings and shelf baskets with sloping front wires, fits wires up to Ø 5 mm, white.

23400-26SU 10

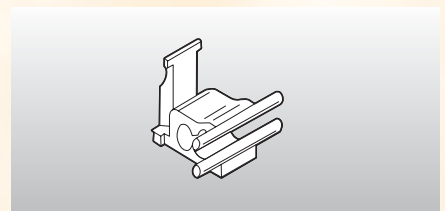

Tube clip (315)

For sales stands, clothes rails, tables etc., fits tube Ø 23 - 28 mm, white.

23500-26SU 10

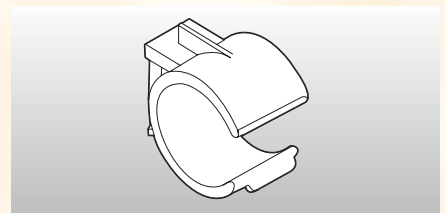

Oval tube clip (341)

Fits oval tubes 15 x 30 mm, clear

23510-00SU 10

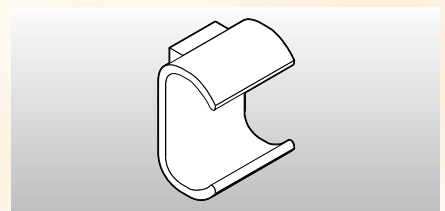

Slatwall-Clip (331)

Fits slatwalls, white

23780-26SU 10

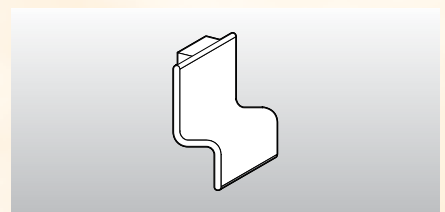



Fastener for Minikomet sales stand (346)

For fastening Klick barkers on horizontal square tubes 21,2 x 21,2 mm, clear.

23460-00SU 10

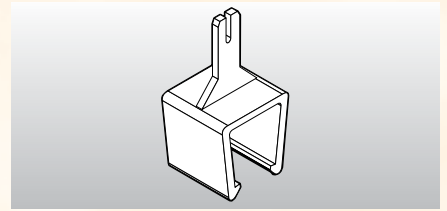

Suction cup clip (336)

For a quick attachment of Klick barkers to smooth surfaces such as glass etc., clear.

23700-00SU 10

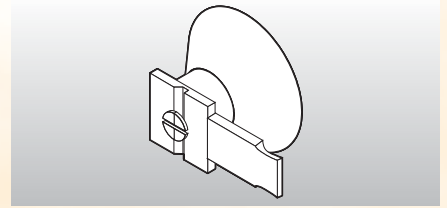

Holder hinged, swivel-type (308)

For price marking directly on the article, e.g. wool, swivel-type, white

23830-26SU 10

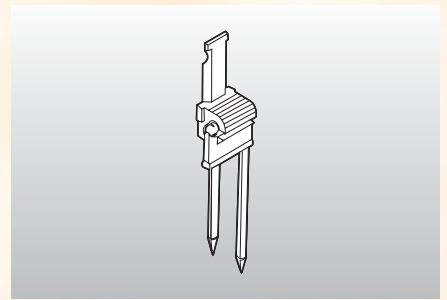

Metal stickpin (334)

With stainless steel needle (Nirosta)

23820-00SU 10

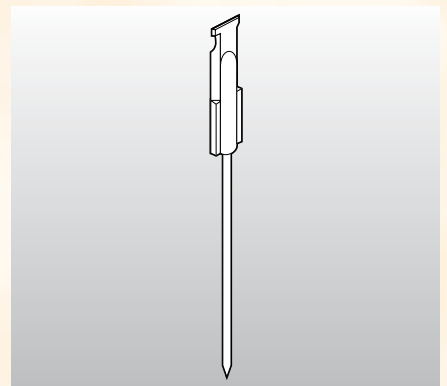

Klick tube adaptor (337)

To connect Klick barkers to chromium tubes, Ø 10 mm, grey. For suitable tubes please see chapter "Components".

23810-03SU 10

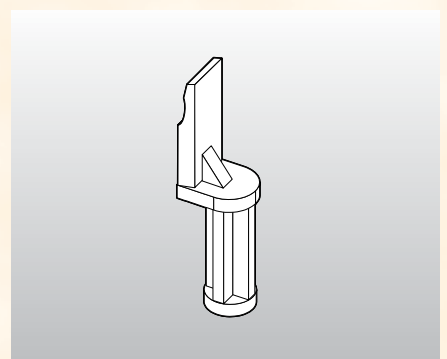

Connector (328)

To connect several Klick barkers or price barkers, clear.

23010-00SU 10

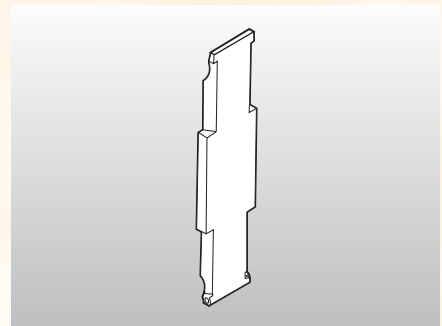

Wall fastener

For invisible fastening of Klick barkers, used with screws or double adhesive, clear.

For screws (345)

23130-00SU 10

With double adhesive (345a)

23131-00SU 10

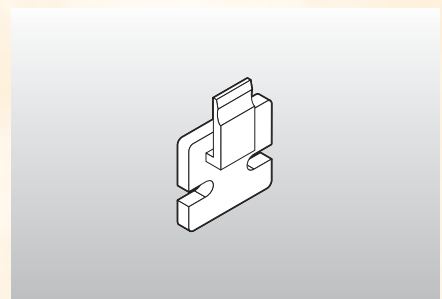

Hinged adaptor (326)

With film hinge, swivel-type, clear.

23140-00SU 10

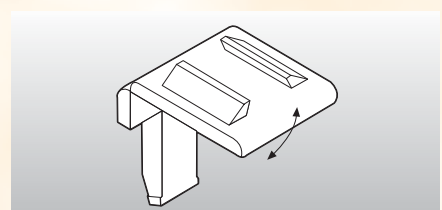

Adhesive plate (327)

With double adhesive, foam-back, for direct fixing to cards, chalk boards etc. and combination with Klick accessories, white.

23150-01SU 10

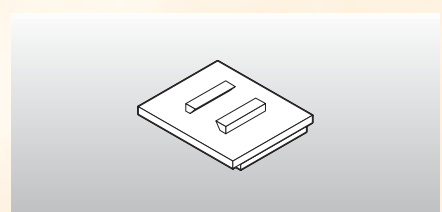

Swivel hinge

To fix Klick barkers in an inclined angle in connection with the FK connector (351) and different elements such as (316), (320) or (319), clear.

23815-00SU 10

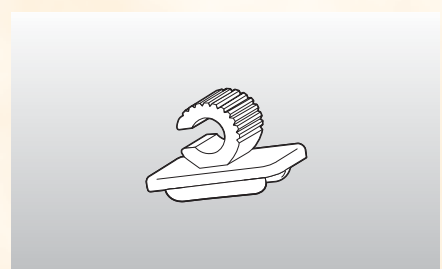

FK base (350)

With ratched for the fitting of FK rods 200, 100 and 50 mm. Colours: white and clear.

23900-xx.....SU 10

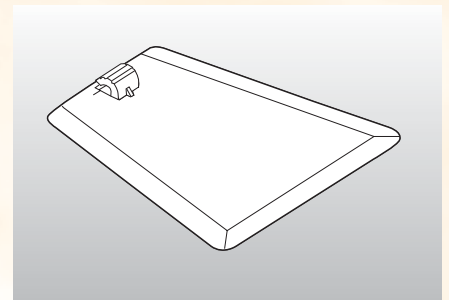

FK rod

With Klick adaptor, to be used in combination with (350), (355) and (356), in lengths 200, 100, 50 mm. Colours: white and clear.

- FK rod 200 mm (352)**
23920-xx.....SU 10
- FK rod 100 mm (353)**
23910-xx.....SU 10
- FK rod 50 mm (354)**
23905-xx.....SU 10

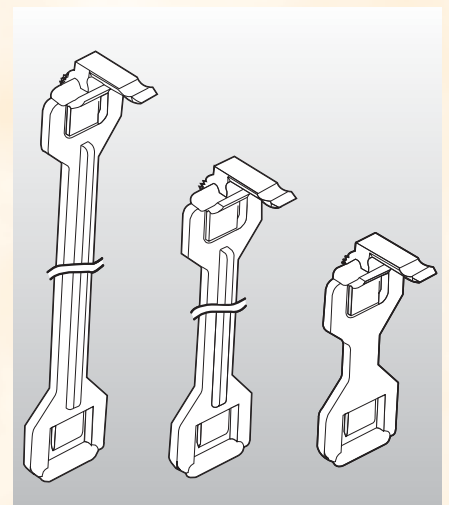

FK connector (351)

With Klick adaptor, to connect e.g. universal or tray clip with price barkers or cassettes. Colours: white and clear.

23940-xx.....SU 10

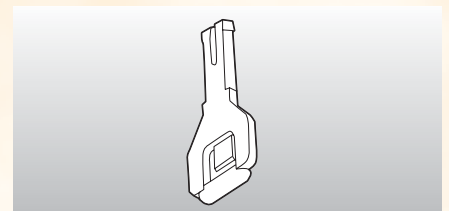

FK universal clip (356)

For an universal fitting of Klick barkers. Colours: white and clear.

23960-xx.....SU 10

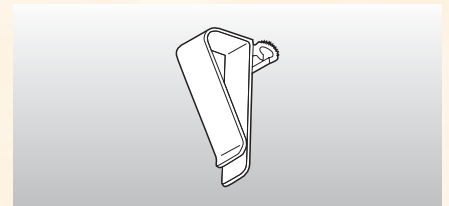

FK tray clip (355)

For fitting Klick barkers to trays, used in combination with FK connector (351). Colours: white and clear.

23950-xx.....SU 10

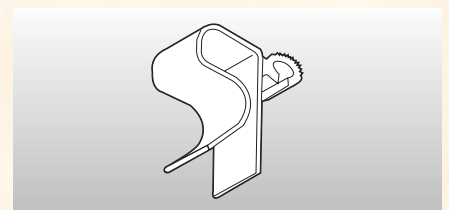



KL stand

KL base grey with aluminium tube Ø 6 mm, in 200 and 400 mm lengths with adjustable Klick adaptor to take Klick barkers or cardholder (please order separately).

KL stand 200
38400-91/6/200SU 10

KL stand 400
38400-91/6/400SU 10



Stake

Aluminium tube Ø 6 mm, in 200, 400, 600 and 800 mm lengths, with grey plastic stake and adjustable Klick adaptor to take Klick barkers or cardholder (please order separately).

Stake 200
38401-91/6/200SU 10

Stake 400
38401-91/6/400SU 10

Stake 600
38401-91/6/600SU 10

Stake 800
38401-91/6/800SU 10

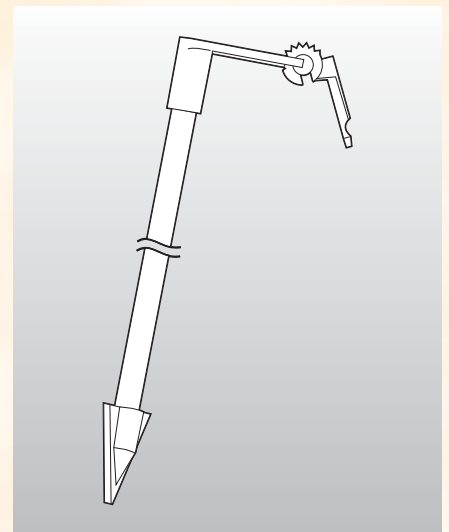

Chalk boards

Black coated Polystyrene, suitable for frames of same size, thickness 1 mm, rounded edges, black

A8
29680-10SU 10

A7
29670-10SU 10

A6
29660-10SU 10

148x70 mm
29691-10SU 10

210x59 mm
29683-10SU 10

210x74 mm
29684-10SU 10

210x99 mm
29688-10SU 10

Shopper stopper

Our shopper stoppers are real attention grabbers. Therefore they are particularly suitable for promoting new products and special offers - working as a real shopper stopper!

Remark:

If frames will be required in a different colour than shown, we gladly will produce them in one of our standard colours, please note a minimum order quantity of 1000 pieces.

Shopper stopper SC



To insert in scanner rail up to 39 mm height, for cards 0,3 - 0,6 mm thickness, 90° to the shelf, clear.

17001-00SU 10

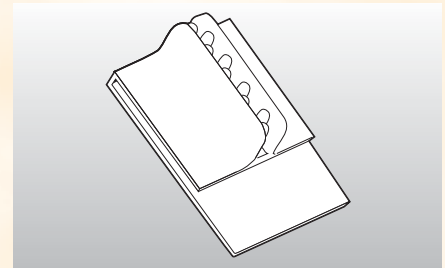

Shopper stopper RS with swivel frame



To fix to metal shelving, due to gravity the frame swivels 90° to the shelf, swivel arm and magnet in white, frame: white, red, grey.

A6 landscape
33956-xxSU 10
A6 portrait
33966-xxSU 10

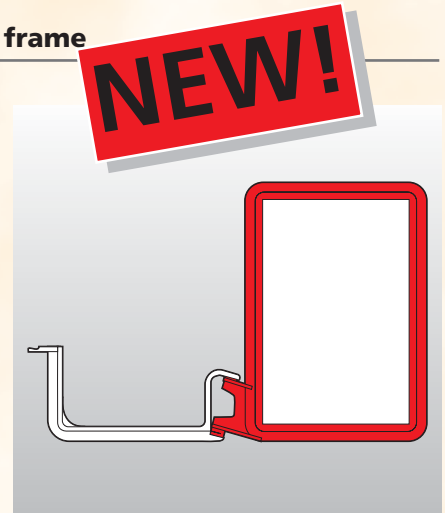

Shopper stopper RS with swivel frame and clip for wire baskets



To fix to metal wire shelving, suitable for wire distances up to 40 mm with a wire Ø of 2 - 5 mm, swivel arm and wire clip in white, frame: white, red, grey.

A6 landscape
33976-xxSU 10
A6 portrait
33986-xxSU 10



NEW!

Shopper stopper RS with long arm and swivel frame

With a longer arm (length 85 mm, height 47 mm) especially suitable for metal shelving with integrated lighting, swivel arm and magnet in white, frame: white, red, green.

A6 landscape
33957-xx.....SU 10

A6 portrait
33967-xx.....SU 10

Shopper stopper RS

Version with magnet for mounting to metal shelves, with adhesive plate to wooden shelves. The spring swivels the frame back to starting position (90° to shelf), swivel arm and magnet in white, frame: white, red, green.

A5 landscape with magnet
33915-xx.....SU 10

A6 landscape with magnet
33916-xx.....SU 10

A6 landscape with adhesive plate
33917-xx.....SU 10

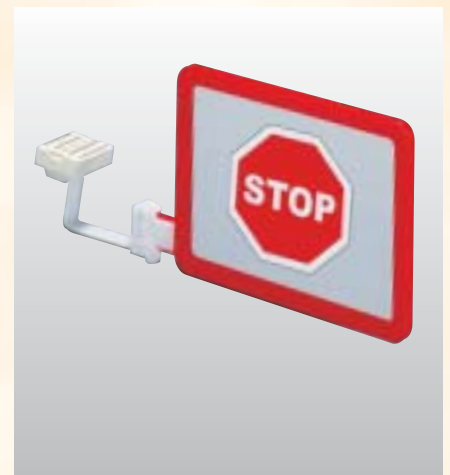

Function scheme (with RS frame)

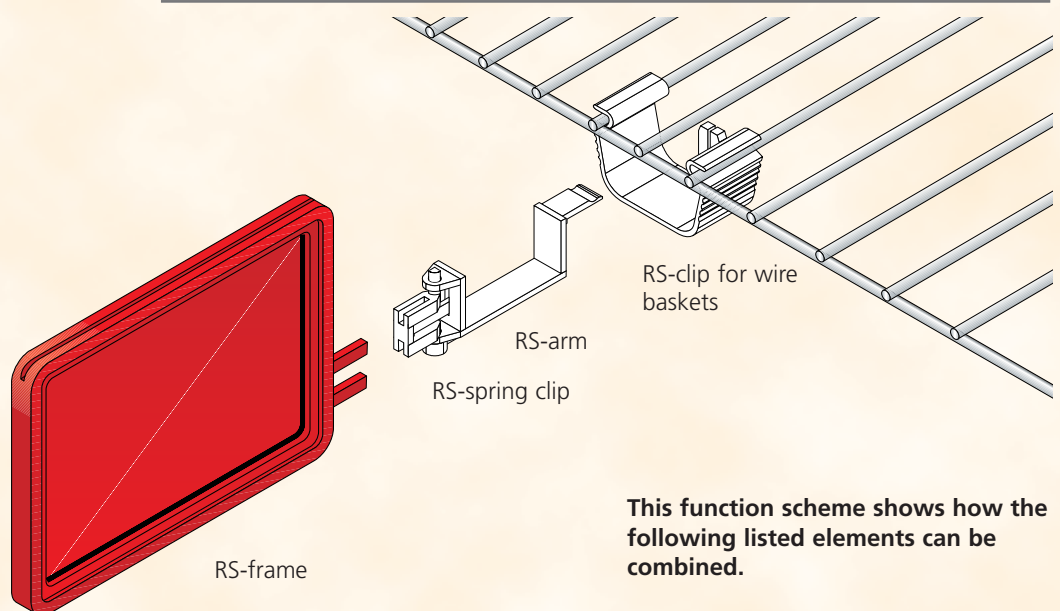

This function scheme shows how the following listed elements can be combined.

RS frame

To combine with spring clip, arm and magnet, landscape. Colours: white, red, green.

- A5 (655)**
16500-xx.....SU 10
- A6 (666)**
16600-xx.....SU 10

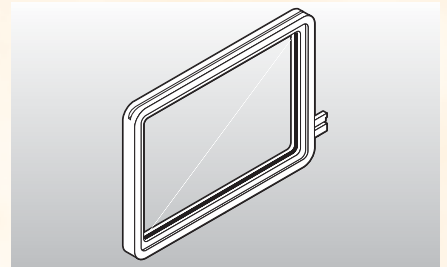

RS swivel arm (602/603)

Spring clip 602 and arm 603 mounted to swivel arm, white.

- 26020-26.....SU 10

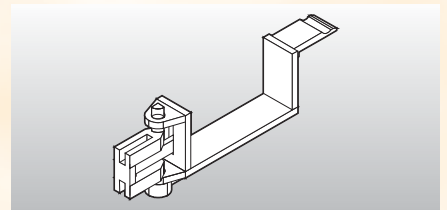

RS clip for wire baskets (604)

Suitable for wire distances up to 40 mm with a wire Ø of 2 - 5 mm, white, also to be used as Klick accessory part.

- 26040-26.....SU 10

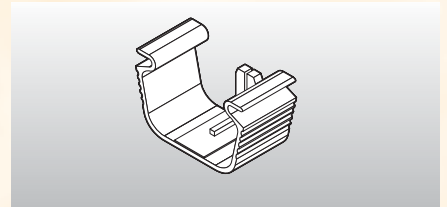

RS magnet (606)

Magnetic holder to take RS swivel arm, white.

- 26230-01.....SU 10

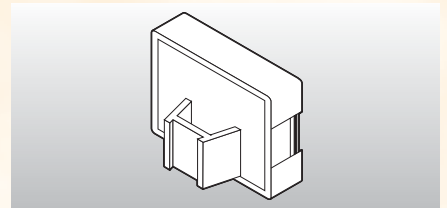

RS frame clip (601)

By this clip standard frames, series 100 can be used as RS frames, clip colour: white

- 26010-26.....SU 10

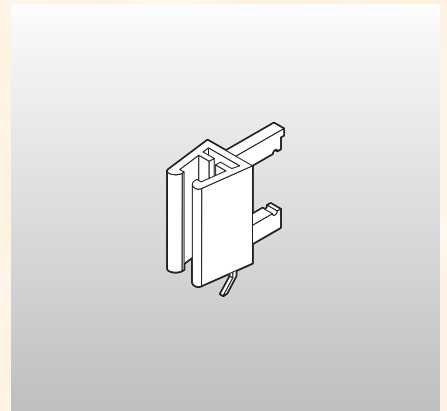

RS spring clip (602)

Swivels arm back to start position, white.

26022-26SU 10

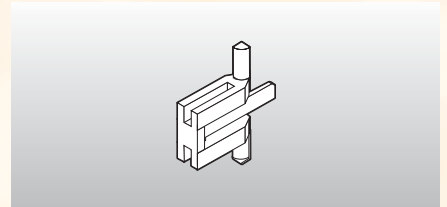

RS arm (603)

To connect spring clip with magnet or clip for wire baskets, white.

26023-26SU 10

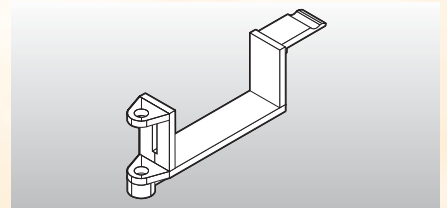

RS swivel connector with double adhesive (608)

To glue directly to smooth surfaces with double adhesive, white.

26051-01SU 10

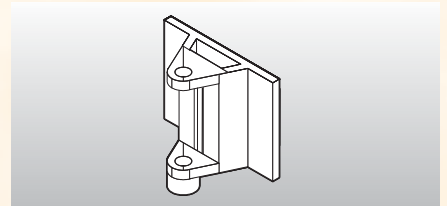

RS Klick connector (605)

Connecting adaptor for Klick fittings, white. Suitable accessories for this application you will find under chapter "Accessories Klick".

26050-26SU 10

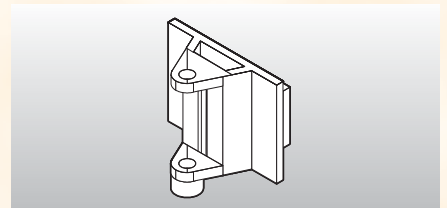

Adhesive plate (327)

With double adhesive, foam-back, for direct fixing to cards, chalk boards etc. and combination with Klick accessories, white.

23150-01SU 10

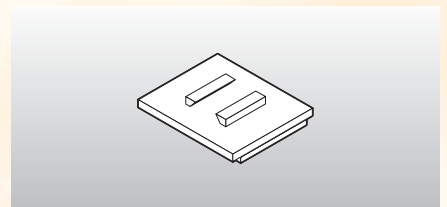

Klick RS arm (609)

To fix Klick frames e.g. to shelves with adhesive plate (327), RS-magnet (606), wire clip (604), white, etc.

26060-01SU 10

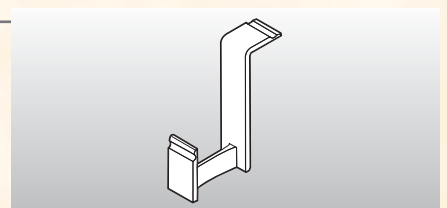

NEW!



Shopper stopper for peg board

To attach to pegboards with hole centres at 30mm (corresponds to European standard), plug components zinc-plated with tube holder grey, fixed chromium tube 310 mm and elastic frame clips. The frame (series 100) is safely held and swings back into start position. Frame to be ordered separately.

21725-03/310.....SU 10

